



300 VAC maximum,
50/60 Hz

E31CT0



E31CT3



E31CT1

300 VAC maximum (CE),
600 VAC maximum (UL),
50/60 Hz

E31CT_x

Split-Core Current Transducers for
Branch Circuit Power Monitoring Systems

Product Overview

E31CT_x split-core devices are designed to work with the E31 panelboard monitoring system. The E31 can accommodate up to 84 split-core CTs to monitor current in up to two panelboards. Available CTs are rated for 50 A, 100 A, or 200 A.

Product Identification

Product	Description
E31CT0	50A split-core CT
E31CT1	100A split-core CT
E31CT3	200A split-core CT

Order additional split-core CTs for your panelboard monitoring system in single units. Contact your local sales representative for available options.



DANGER

HAZARD OF ELECTRIC SHOCK, EXPLOSION, OR ARC FLASH

- Follow safe electrical work practices. See NFPA 70E in the USA, or applicable local codes.
- This equipment must only be installed and serviced by qualified electrical personnel.
- Read, understand and follow the instructions before installing this product.
- Turn off all power supplying equipment before working on or inside the equipment.
- Use a properly rated voltage sensing device to confirm power is off.
- DO NOT DEPEND ON THIS PRODUCT FOR VOLTAGE INDICATION**
- Only install this product on insulated conductors.

Failure to follow these instructions will result in death or serious injury.

A qualified person is one who has skills and knowledge related to the construction and operation of this electrical equipment and the installation, and has received safety training to recognize and avoid the hazards involved. NEC2011 Article 100
No responsibility is assumed by Veris Industries for any consequences arising out of the use of this material.

NOTICE

- This product is not intended for life or safety applications.
- Do not install this product in hazardous or classified locations.
- The installer is responsible for conformance to all applicable codes.
- Mount this product inside a suitable fire and electrical enclosure.

Dimensions

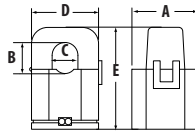

E31CT0 50 Amp

- A = 1.0" (26 mm)
- B = 0.5" (11 mm)
- C = 0.4" (10 mm)
- D = 0.9" (23 mm)
- E = 1.6" (40 mm)

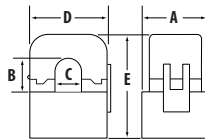

E31CT1 100 Amp

- A = 1.5" (39 mm)
- B = 0.8" (20 mm)
- C = 0.7" (16 mm)
- D = 1.6" (40 mm)
- E = 2.1" (53 mm)

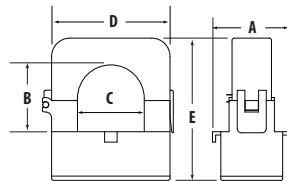

E31CT3 200 Amp

- A = 1.5" (39 mm)
- B = 1.25" (32 mm)
- C = 1.25" (32 mm)
- D = 2.5" (64 mm)
- E = 2.8" (71 mm)

Installation



Observe precautions for handling static sensitive devices to avoid damage to the circuitry that is not covered under the factory warranty.



Disconnect and lock out power to the electrical panel.

1. Locate the tiered terminal blocks on the adapter board. Connect the CT wires to the terminal blocks as shown. When tightening terminals, apply the correct torque: 0.16 to 0.19 ft-lb (0.22 to 0.26 N-m) for the connectors on the adapter board terminal blocks.

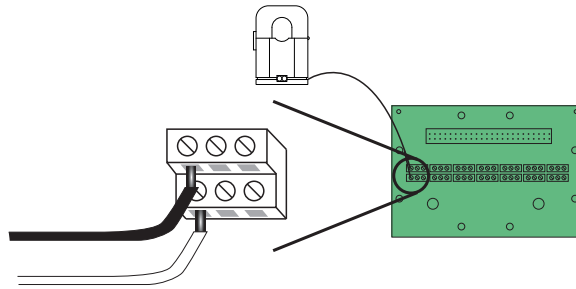

2. Install the current sensors onto the conductors to be monitored. Sensors can be mounted facing either direction; orientation does not affect meter accuracy. **Install E31CT0 on 300 VAC maximum, 50/60 Hz. Install E31CT1 and E31CT3 on 300 VAC max., 50/60 Hz (CE) or 600 VAC max., 50/60 Hz (UL)**

Note: Clean split-core contacts before closing.

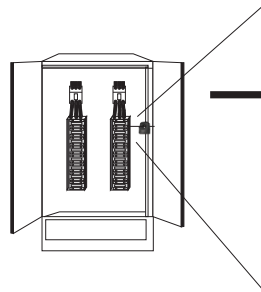

Close CTs until the clasp clicks into place to ensure that contact surfaces are firmly seated.

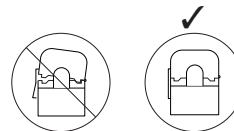

China RoHS Compliance Information

部件名称	产品中有毒有害物质或元素的名称及含量Substances					
	铅 (Pb)	汞 (Hg)	镉 (Cd)	六价铬 (Cr (VI))	多溴联苯 (PBB)	多溴二苯醚 (PBDE)
塑料部件	0	0	0	0	X	X
0 = 表示该有毒有害物质在该部件所有均质材料中的含量均在 SJ/T11363-2006 标准规定的限量要求以下。 X = 表示该有毒有害物质至少在该部件的某一均质材料中的含量超出SJ/T11363-2006标准规定的限量要求。						
Z000215-0A						